

Lightscape Design

TRIDOME STRUCTURES
INVITES YOU IN.....
into living architecture
shaped by light, form
and experience.



TRIDOME
STRUCTURES





TRIDOME STRUCTURES

Architecturally inspired, sustainably built and designed for the future.

About us

At Tridome, we aim to create vibrant environments that nurture people, communities, and our planet. By doing so, we are helping solve a problem we refer to as the EPSP impact on our built environment. It's our holistic framework for understanding and enhancing the Environmental, Psychological, Social, and Physical effects that our built environment has on us and the planet we all share.

Why Choose Tridome

We approach each project as a site-specific opportunity to transform space into a story. As designers and fabricators, we specialize in architectural art pieces that blur the boundary between built form and natural setting. Our structures do not sit on the landscape. They belong to it.

Whether responding to a moonlit path, a quiet courtyard, or enjoying the gardens, we shape experiences that unfold across time. Light, shadow, texture, and sound are all materials in our palette. We are as attuned to technical detail as we are to emotional impact.

What sets us apart is how we listen. To the site. To the brief. To the people who will walk through and wonder. With every project, we bring form, precision, and a commitment to designing with care so that each piece not only works but lingers in memory.

Crafting Experiential Spaces

Extraordinary spaces offer more than beauty. They hold memory, story, and transformation. Our role is to listen to those layers and design architectural art pieces that don't distract from the moment but draw people deeper into it.

INVITING YOU IN.



Lightscape Designs



Singing in the Rain



WHIMSICAL BUBBLE UMBRELLA SEATING

- Wood Structure made from Glulam and MicroCLT
- Top
 - Clear Vinyl
 - Vibrant Colored Fabric
 - Luxury Sail Cloth
- Twinkle Lights
- Optional Infrared Heater
- Integrated Base and Bench
- 2-10 Seater
- 5' - 12' Diameter
- Sustainable
- Quick Installation
- Palletized
- Customizable year-after-year



Singing in the Rain:

Crafted for Connection



Highlights

A gathering space shaped by structure, light, and shared pause

Design Features

Glulam Umbrella Structure

Each umbrella is crafted from curved glulam arms that rise from a central post and flare outward, creating a sculptural canopy that feels both elegant and grounded.

Transformable Canopy

The canopy is available in several fabric options, ranging from vibrant colors to clear vinyl and luxury sailcloth. By day, it filters sunlight and frames views of the sky above. By night, it comes alive with cascading strands of integrated lighting.

Integrated Table & Seating

Beneath each umbrella, a circular table made from microCLT is paired with integrated benches that seat 2 to 10 people. The seating is comfortable, durable, and designed for informal gatherings.

Scalable & Adaptable

Umbrellas can be manufactured in various sizes to accommodate any layout. From intimate two-person seating to larger social hubs, the design is flexible and adaptable.

Effortless Installation

Each structure is prefabricated for quick assembly and minimal site impact. Units are free-standing and require no permanent foundation, allowing for reconfiguration or relocation over time.

Tree of Wonder



- Engineered Wood Structure
Made from Glulam
- Top Options
 - Translucent Vinyl
 - Vibrant Colored Fabric
 - Luxury Sail Cloth
- Up to 60' Tall and 80' Diameter

- LED light Strips
- Optional Laser
Projection on Fabric
- Warm Up Lighting

Tree of Wonder

Crafted for Connection



Highlights

Design Features

Glulam Frame

Tapered glulam columns rise skyward in a pure geometric form. Their converging lines draw the eye upward while remaining warm and grounded in tone and texture.

Architectural Fabric

Layered translucent fabric ribbons stretch between each tier, capturing projection and light. These surfaces become a living canvas, glowing softly at dusk, transforming into a tapestry of color and pattern by night.

Programmable Lighting

Dynamic LED lighting embedded within the structure brings the form to life. Waves of color flow across the surface, programmed to shift with the season, soundtrack, or visitor motion. Laser projection option to project into the fabric.

The Star

At its peak, a crystalline geometric capstone made of translucent fabric and light evokes both tree-topper and sculpture.

Pre-fabrication

The structures components are prefabricated with the aim for ease of installation, shipping, and storage.

Emotional Intent

This is a space of uplift and encounter, marked by shared awe beneath illuminated massive form.

Phantom of the Opera

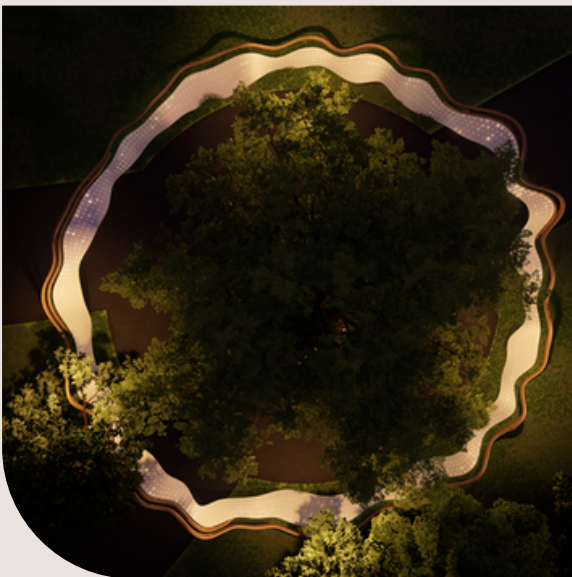

- Fiber Optic Fabric Light
- Removable Translucent Mask
- Warm Up Lighting
- Free Form Glulam



Phantom Oak:

Crafted for Connection



Highlights

A sculptural tribute, adaptable for cultural venues, estates, or hospitality experiences.

Freeform Glulam Structure

Horizontal glulam members sweep through the garden like a musical staff, giving shape to the rising and falling movement of the original score.

Fiber Optic Mesh

Threaded through the glulam is a dynamic mesh of fiber optic strands. This is the score brought to life in light pulsing in rhythm, changing with presence, and glowing vividly as dusk falls. At night, the space becomes a living composition.

The Mask

A translucent, sculptural mask floats within the structure. It is framed in glulam and shaped from rigid but flexible architectural fabric.

The Setting

Set around a mature oak tree, the installation preserves and uplifts the natural form. The light rises through the branches like music, giving reverence to the tree's age and presence.

Emotional Intent

This piece is an invitation to pause, look up, and feel time expand. It connects visitors to the power of stillness and the art of storytelling.

Inviting You In.....
to new possibilities

Expanded Design Portfolio

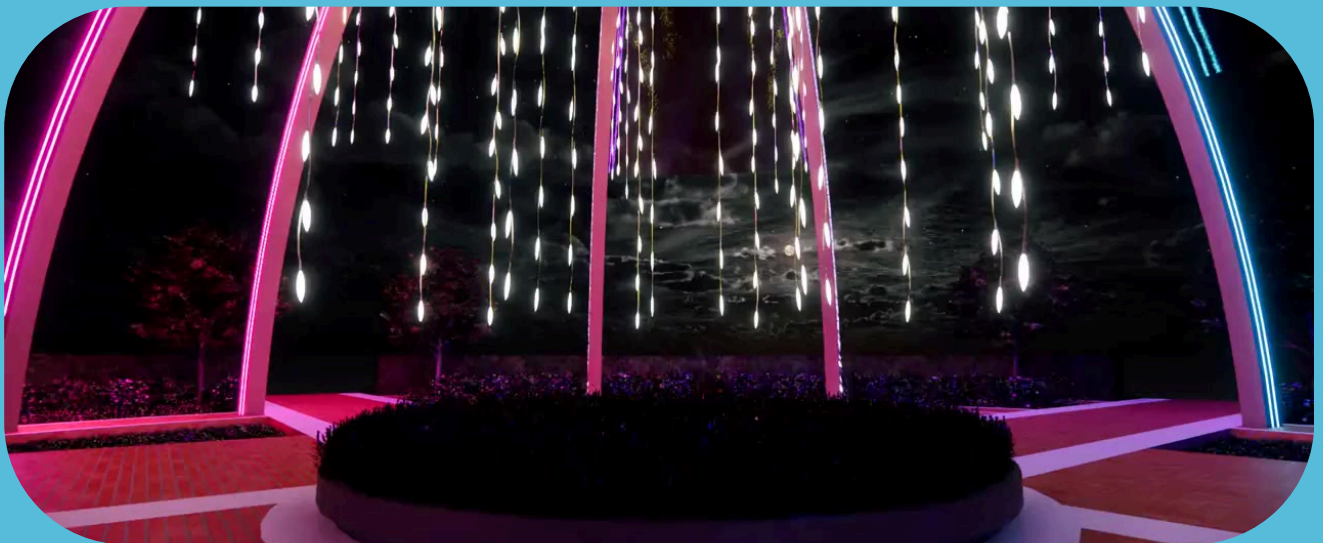
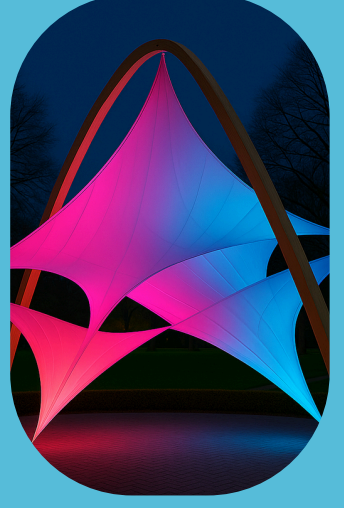

Delivery & Installation

What to Expect

At Tridome Structures, we focus on delivering top-quality prefabricated modular systems designed for seamless integration. Our expertly crafted solutions empower both your trusted installation partners and our recommended contractors to achieve maximum efficiency on-site, ensuring a streamlined and hassle-free setup process



Min 3-4 person assembly crew recommended

- rigging
- hoisting
- assembling
- finished carpentry

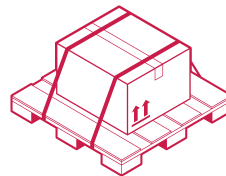

“Flat-Packed”

- prefab elements arrive strategically stacked on semi trailer
- loose items, hardware, and finishes bundled or crated



Recommended Equipment

- short articulated work platforms may assist in securing glulam and fabric
- Spider crane or telehandler



Tools

- Construction industry standard hand tools needed
- Electrical tools for low voltage
- PPE



Guiding Principles



Our overarching principle is: "Always a positive *EPSP* impact." The principle ensures that the products and services we provide always seek to deliver a positive Environmental, Psychological, Social, and Physical result.

ENVIRONMENTAL

We shape light and form to awaken the senses. Using glulam and fabric, each piece responds to the elements catching the wind, filtering the rain, and glowing with intention. Set lightly into the landscape, these installations amplify nature's presence without ever competing with it.

SOCIAL

Even in stillness, we gather. These illuminated pieces create moments of shared wonder, places to pause together, to look up, to feel small beneath something vast. Connection emerges not through instruction but through invitation, woven softly into the light.

PSYCHOLOGICAL

Stillness has form and feeling. We shape light, shadow, and curve to quiet the mind. These moments aren't prescribed, just possible: a place to pause, reflect, or simply exist within something gentle, glowing, and alive.

PHYSICAL

Movement takes many forms. Glulam and fabric create places to stroll slowly or to be stirred by rhythm and light. Some spaces soothe with softness and shadow. Others pulse with color, music, and motion. Together, they guide the body gently and joyfully through the landscape.

Not made to fit in. Built to
stand apart.



TRIDOME STRUCTURES

Our purpose is to create vibrant
environments that nurture people,
communities, and the planet.

Serving Canada, USA and the Planet

Tridome Structure

info@tridomestructures.com
www.tridomestructures.com
[@tridomestructures](#)

Tridome Studios

info@tridomestudios.com
www.tridomestudios.com
[@tridome.studios](#)

